

# How to connect your Instagram account to Mandala Analytics

In order to collect data from the Instagram Platform, you must have a Facebook page connected to your Instagram account. Please make sure you have...

- A Facebook Page
- An Instagram Account



Facebook Page



Connect



Instagram Account

## Connect your Instagram account to a Facebook page

1. Sign in to your Facebook account in a new browser.
2. Select 'Pages' on the left, and then select the page you want to link with your Instagram.

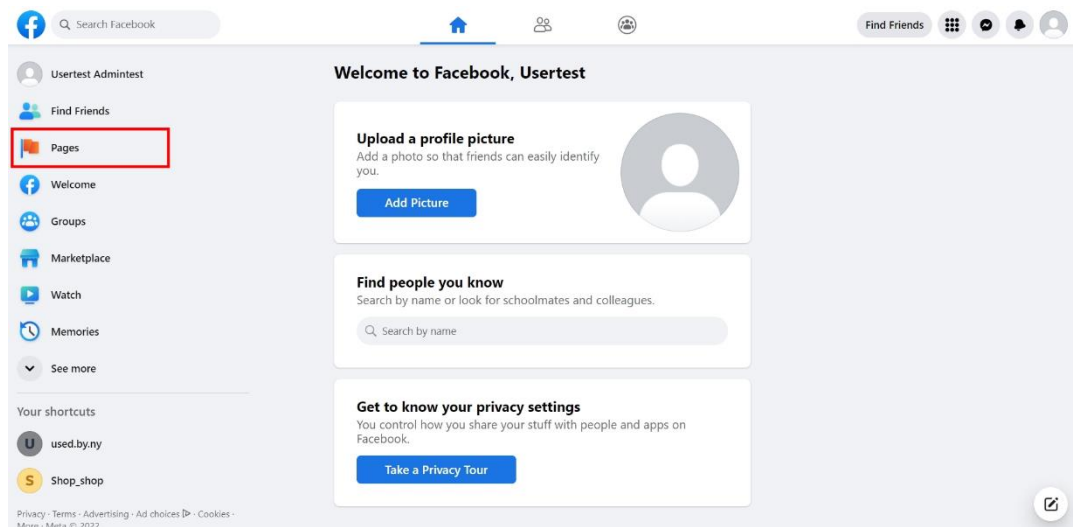

3. At the bottom of 'Manage Page', select Settings from the menu.

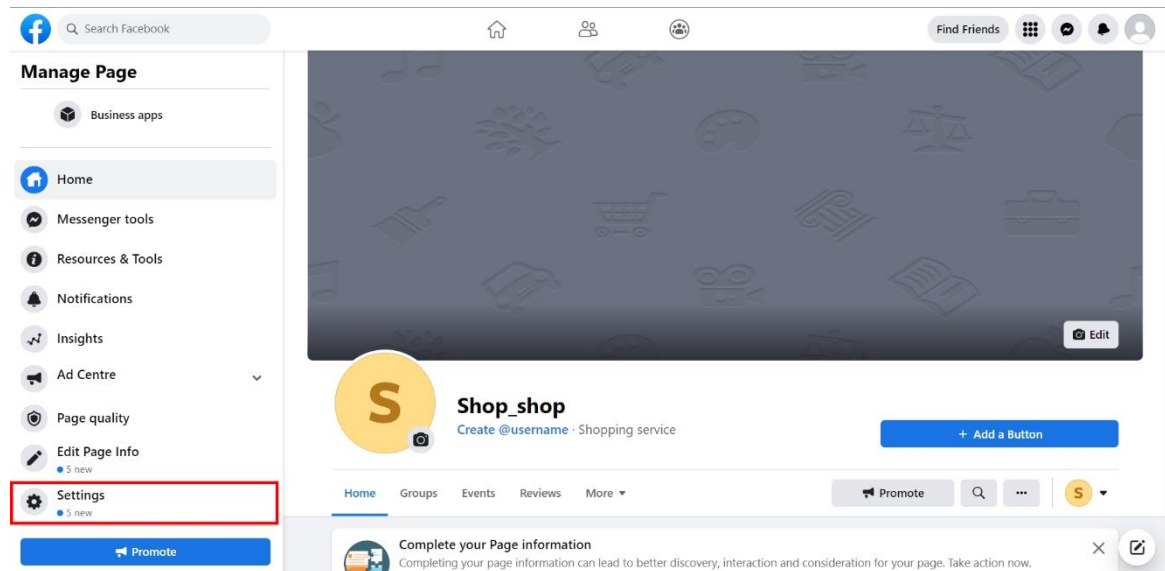

4. Select 'Instagram' from the Page settings menu.

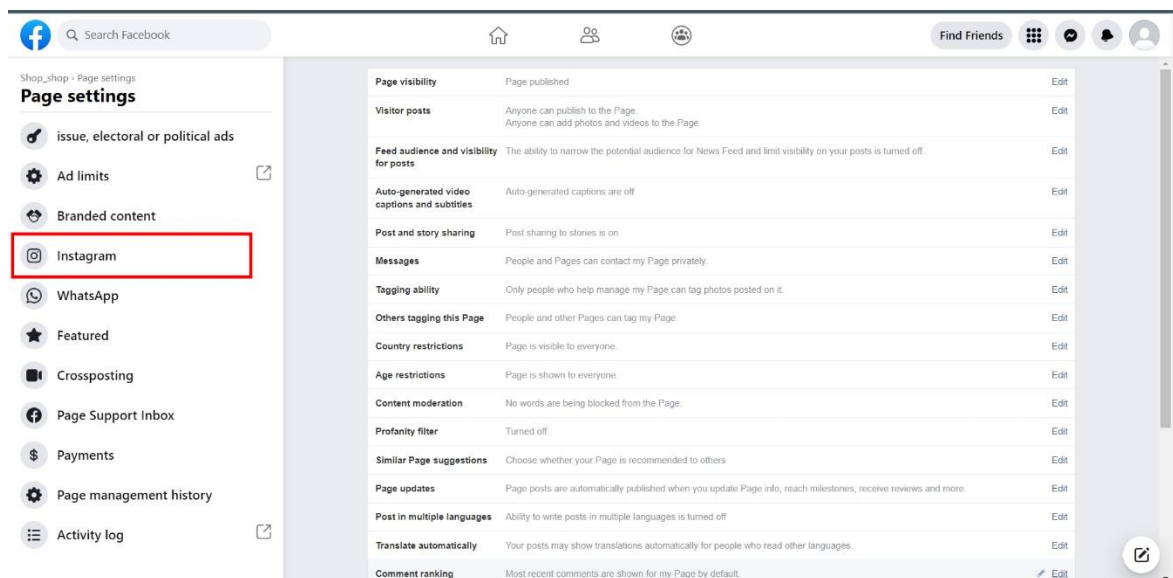

5. Select 'Connect Account'.

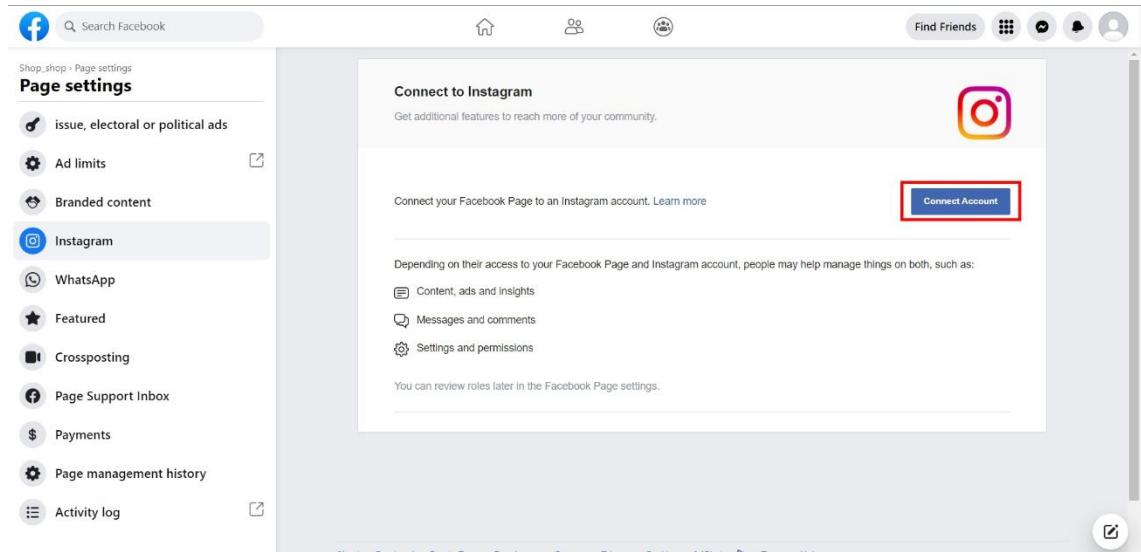

6. Enter your Instagram account credentials (username and password) and then select Login.

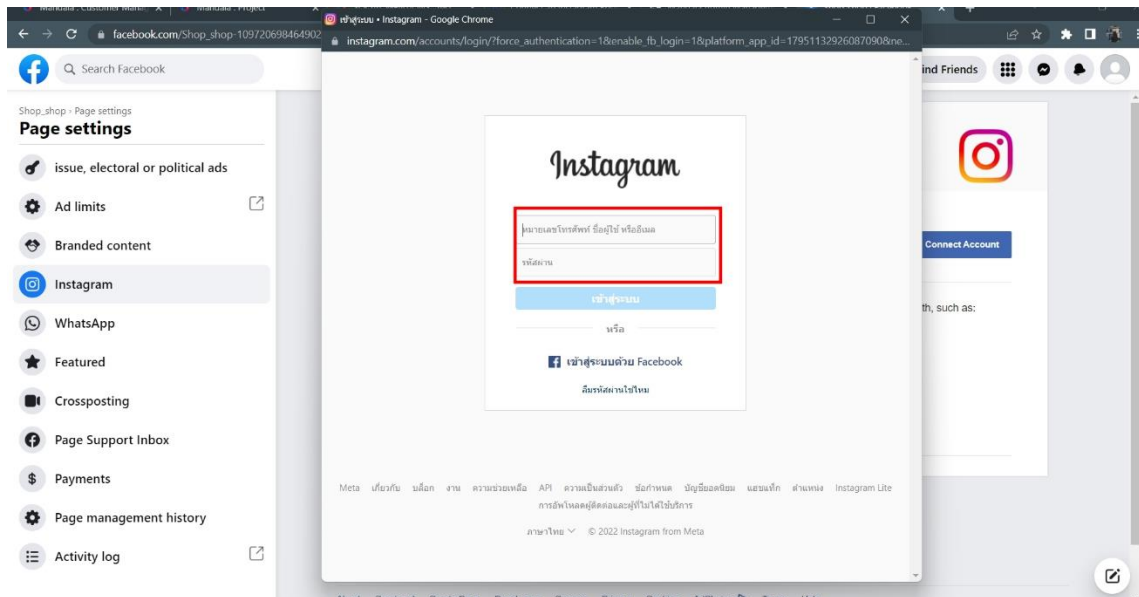

7. If you have a personal Instagram account, it must be switched to a business account. Click on 'Switch Now' to switch to a business account.

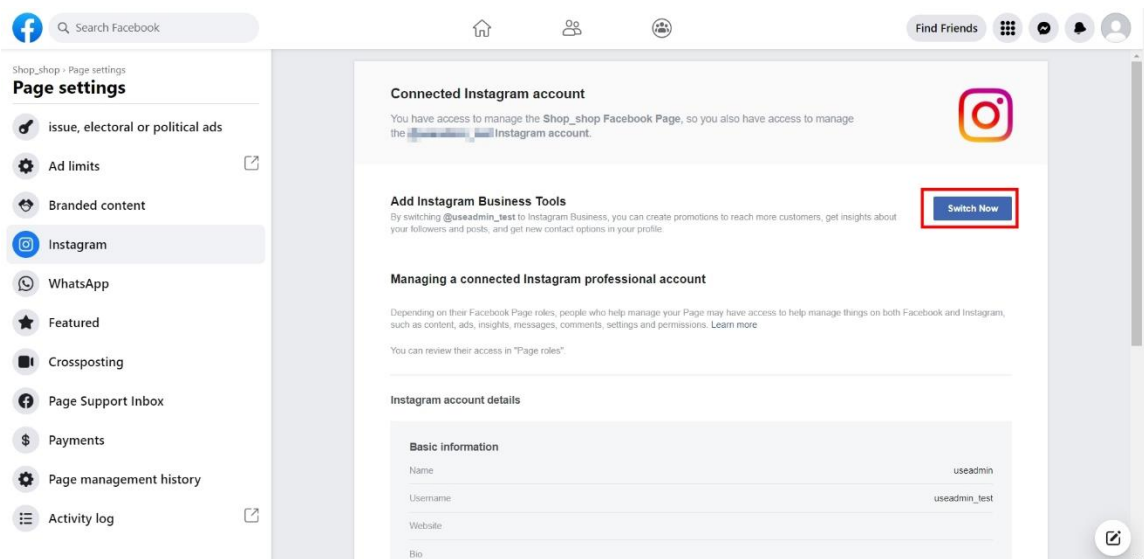

## Connect your Instagram profile to Mandala Analytics

You can add your Instagram profile to Mandala Analytics once you have successfully connected the Instagram account to your Facebook page.



With the following steps:

1. Select the Instagram platform

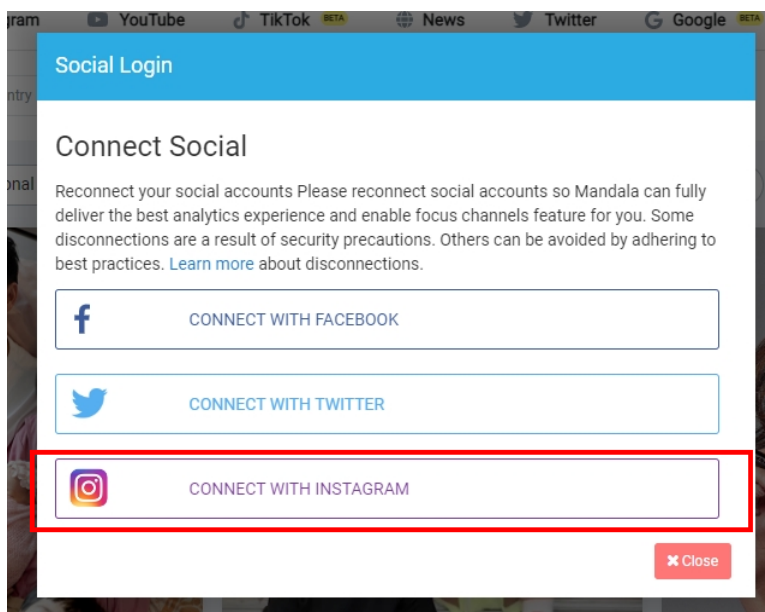

2. Click continue as your profile

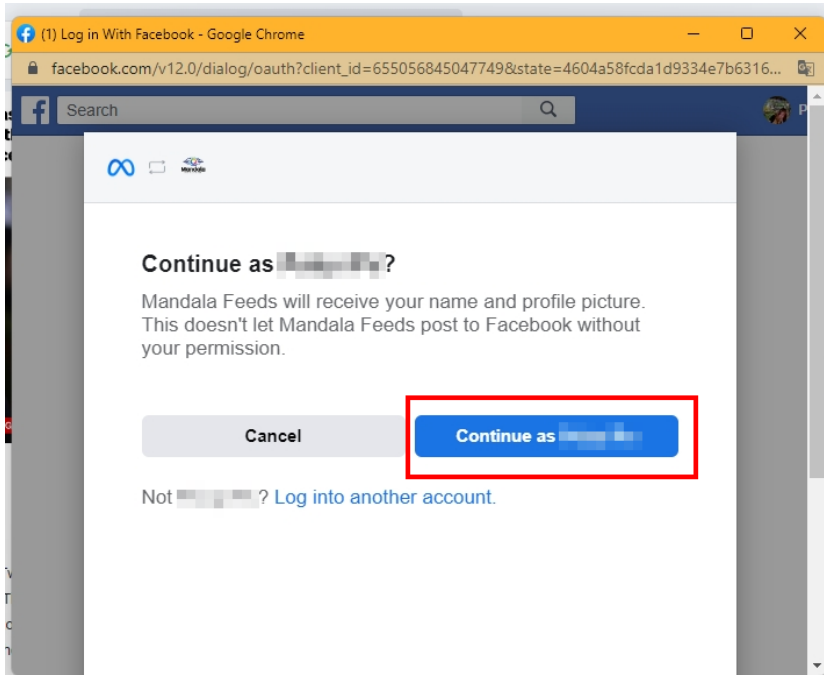

3. Select the Instagram profile you want to connect to.

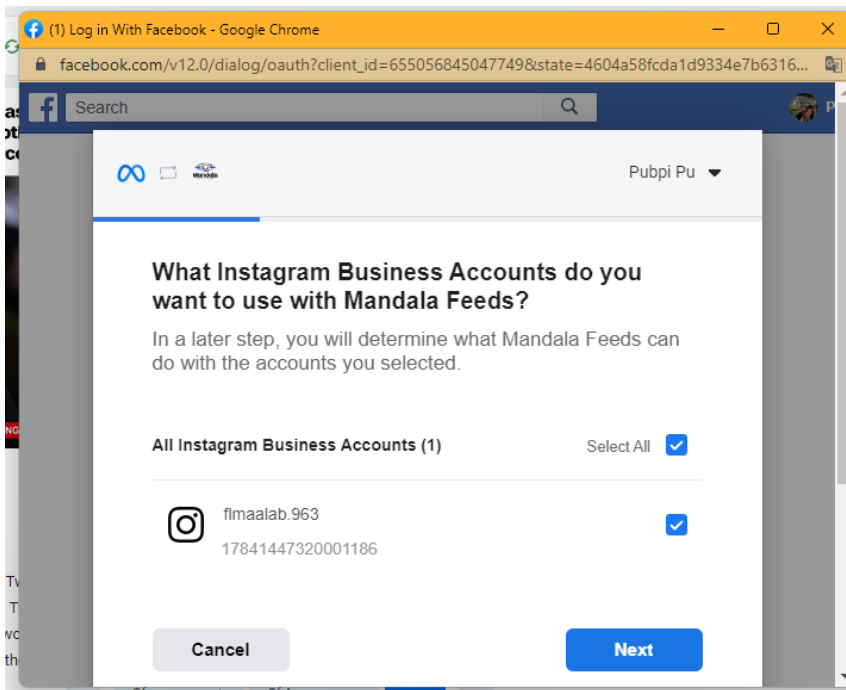

4. Select the Facebook page you have connected to Instagram, if you don't select it, or select another page that is not connected between Facebook and Instagram, Mandala's system will not be able to connect to Instagram.

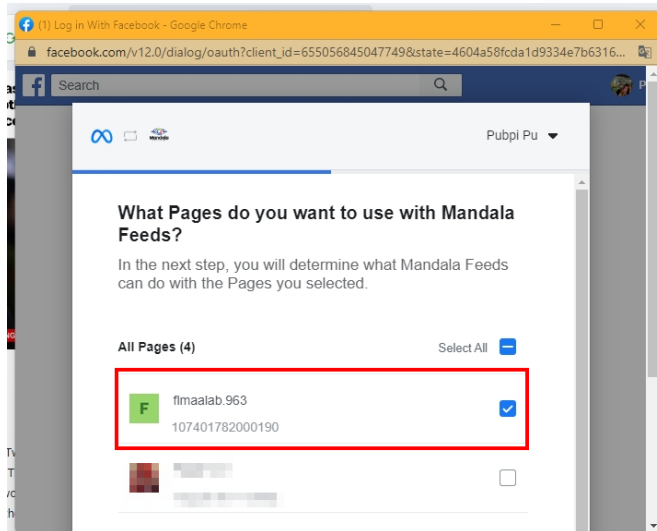

5. Grant permission to access profiles. Mandala requires permission to [access profiles and posts from the Instagram account connected to your page](#), [access insights for the Instagram account connected to your page](#), and [show a list of the pages you manage](#). If you decline, Mandala system will not be able to connect to the platform.

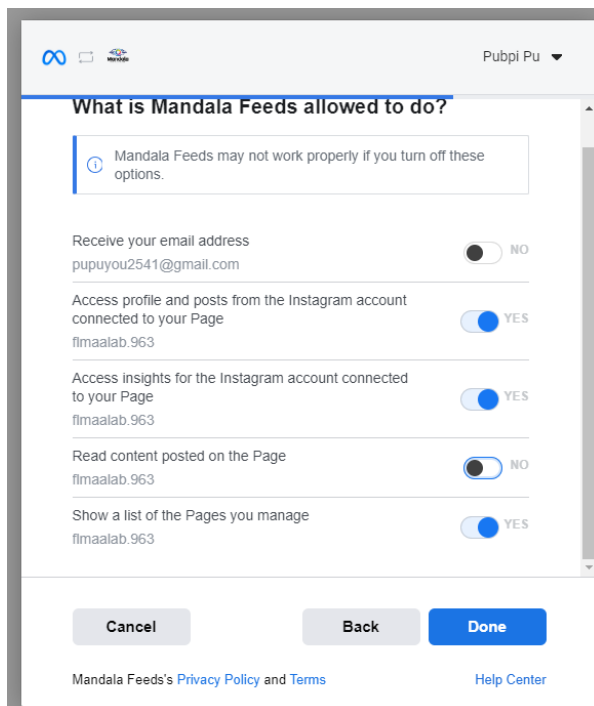

Things that may prevent Mandala from connecting to your Instagram platform or prevent you from using Mandala include:

1. Your Instagram account is not a Business Account and is not connected to Facebook.
2. When you chose to 'allow', your Instagram Business Account didn't match the Facebook page you're connected to, or you allowed other pages that are not connected to your Instagram Business Account instead.
3. When you do not grant permission to access insights on Instagram accounts connected to your Page, this will prevent you from searching for channels from the Instagram platform in Mandala's system.

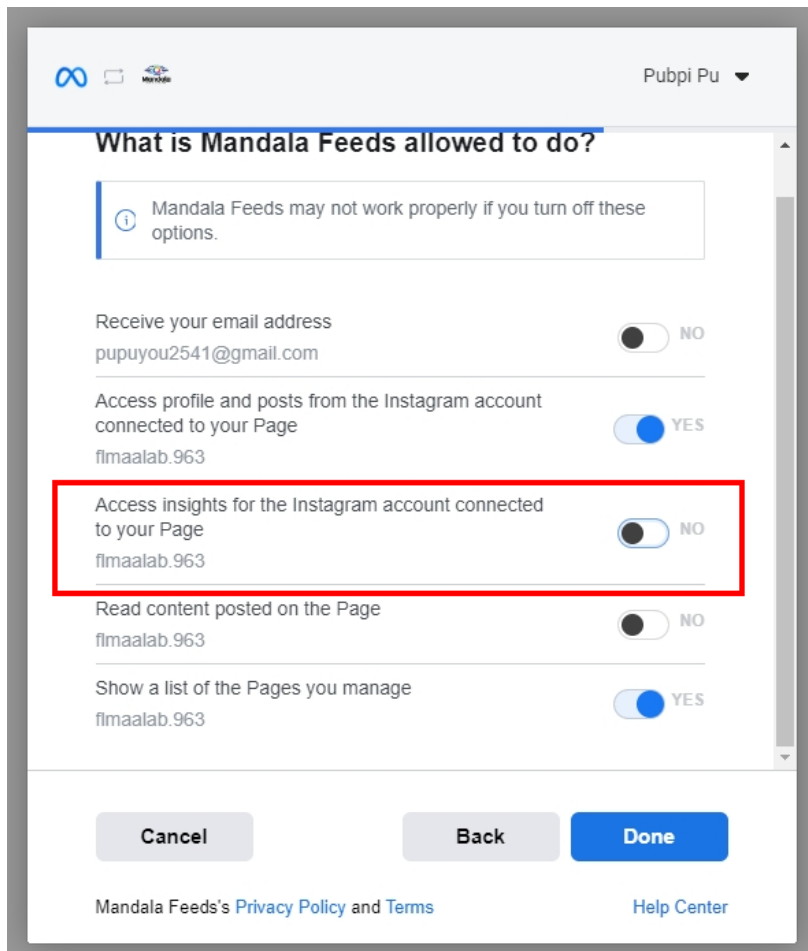



- When you do not grant permission to access profiles and posts from an Instagram account connected to your page, along with permission to display a list of pages you manage, the Mandala system will not be able to access your account and confirm that your Instagram Business account has been connected to your Facebook page successfully (according to the conditions specified by the Platform).

